

WILLIAM W. CAUDILL CITATION

Parkrose High School Community Center Portland, Oregon

Client: Parkrose School District
Jacki L. Cottingham, former Superintendent

Firm: Dull Olson Weekes Architects

Design team: John Weekes, Principal-in-Charge; Mark Siemieniec, Susan Emmons, Jeff Johanson, Doug Nelson, Design Team

Capacity: 1,000
Space/student: 220 sq. ft.
Area: 220,000 sq. ft.
Total cost: \$24 million
Cost/square foot: \$109
Completion: December 1997

The goal was to support a strong community desire to create a facility that promotes interaction between school and community. Therefore, the new Parkrose High School Community Center was designed to create a community focus and institution for life-long learning.

The building is envisioned to be both a learning institution and community-use facility. Learning areas and community center functions are linked by the student center. Traditional gymnasium, weight rooms and performing-arts functions have been designed to accommodate both school and public use.

The school has four core instructional areas called regions. They are:

- Small seminar rooms that are convertible to larger rooms;
- "W e t" rooms for science and applied learning activities;
- Teacher's



Student center



Learning center



County public library



Entrance lobby



Gymnasium



Performing arts



Expandable seminar spaces

“Very interesting combination of design use for school and community. This is truly a ‘community’ facility.”

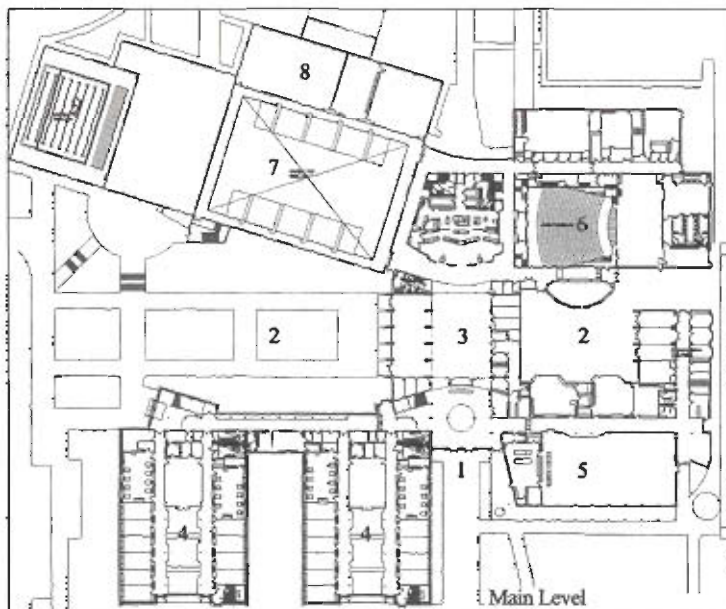

LEGEND

1. Entrance
2. Courtyard
3. Student center
4. Core instructional area
5. County public library
6. Performing arts center/ Auditorium
7. Wellness center/ Gymnasium
8. Wellness center/ Fitness center
9. Wellness center/ Aquatic center

office surrounding common large-group activity areas;

- Decentralized administration and counseling.

Each region is considered a home base for students and is a flexible response to changing curriculum and learning methods.

A hub of activity, the student center is surrounded by student businesses.

The prominent community center contains a county public library, social-services offices, job-placement offices and public meeting rooms.